



Door Closer

# DORMA TS 77

- The economical solution for standard doors.
- Non-handed, suitable for standard, parallel arm and frame installation, one model to cover size EN 3 and EN 4.
- Fully controlled closing cycle.
- Surface finish for optimum corrosion protection.
- Available with rectangular clip-on cover (optional extra).

**Standard and optional functions**

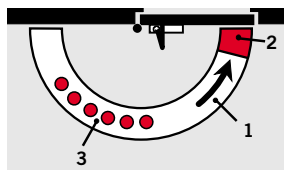

Example: left-hand (ISO 6) door, pull side fixing

- 1 Fully controlled closing with speed adjustable between 180° or 120° and 20°
- 2 Adjustable latching action adjustable between 20° and 0°
- 3 Hold-open range if equipped with hold-open arm (optional extra)

**Data and features TS 77**

		EN 3	EN 4
Closing force	Size		
Standard doors up to <sup>1)</sup>	950 mm	●	–
	1100 mm	–	●
External doors, opening outwards		–	–
Non-handed		●	●
Arm assembly type	Standard	●	●
	Slide channel	–	–
Closing force variable at adjustment screw		–	–
Closing speed variable by valve adjustment		●	●
Backcheck		–	–
Delayed action		–	–
Hold-open		○	○
Weight in kg		1.7	
Dimensions in mm	Length	180	
	Overall depth	65	
	Height	43	

● Yes – No ○ Option

1) For applications involving particularly heavy doors and doors which have to close against wind resistance, we recommend the DORMA TS 83.

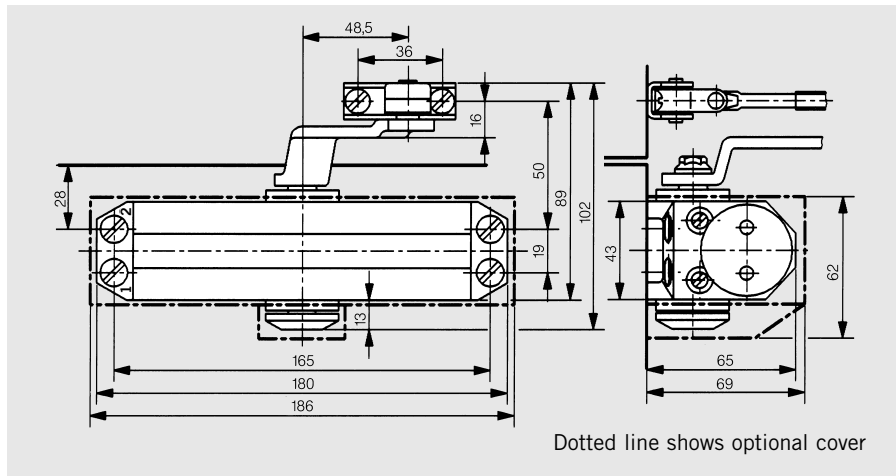

Dotted line shows optional cover

**Specification text**

Rack-and-pinion door closer with hydraulically fully controlled closing cycle, non-handed, template adjustable for size EN 3 and EN 4.

**Model:**

- Size EN 3
- Size EN 4
- With hold-open arm

**Accessories:** \_\_\_\_\_

**Closer Colour:**

- silver  dark brown

**Clip-on cover**

- silver  white  gold

**Make:** DORMA TS 77

**Applications and fixing**

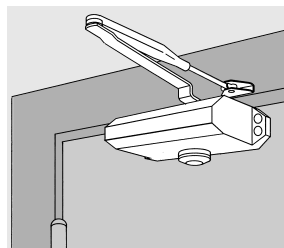

... on the pull side  
Door leaf fixing (standard)

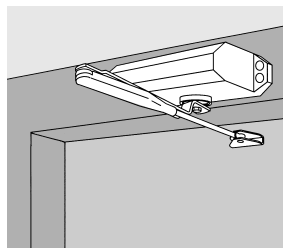

... on the push side  
Transom fixing (overhead installation)

**Accessories**

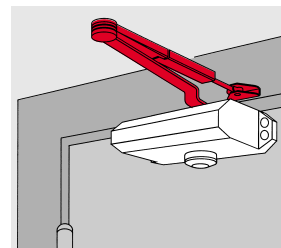

... with hold-open arm assembly  
for temporary door hold-open (optional extra)

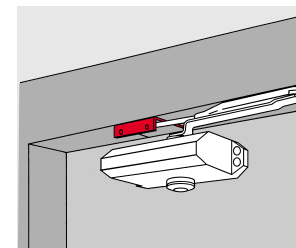

... parallel arm  
for parallel arm assembly (for installation dimensions, see fixing instructions)

**DORMA GmbH + Co. KG**  
 P.O. Box 4009  
 58247 Ennepetal  
 Germany  
 Tel. +49 (0)23 33/7 93-0  
 Fax +49 (0)23 33/79 34 95  
 www.dorma.com